



Double Glass Door Merchandisers



| Model |
|----------------|
| EGD-2DR-36-HC |
| EGD-2DR-47-HC |
| *EGD-2DR-48-HC |
| EGD-2DF-36-HC |
| EGD-2DF-48-HC |

Energy Star 5.0 Approved

STANDARD FEATURES

- CFC Free Refrigerant and foam
- Triple Pane Glass Doors with Heat Reflecting Film
- Very Bright LED Lighting
- Locks on the Doors
- Energy Star Efficient Refrigeration System on Refrigerator Model EGD-2DR-48-HC only
- Adjustable Heavy Duty Coated Shelves
- High Density Insulation
- Digital Control System for accurate Temperature Control
- Removable Door Gaskets
- Whisper Quiet, high efficient Compressor
- Visually Appealing to Compliment Products Stored
- Economically Designed Door Handle
- Bottom Mount, slide out Condenser
- **WARRANTY:** Two year parts and labor, with an addition 3 years on the compressor

*Not suitable for installation in a non-commercial or residential applications.

| Items | Description | Items | Description |
|-------------------|---|----------------------|---|
| External top/side | Black coated steel | Temperature control | Solid State T-stat with Digital Display |
| Door | Glass – triple pane, tempered | Comply to standard | ETL LISTED |
| External back | Aluminum | Refrigerating system | Capillary tube |
| Cabinet internal | Aluminum – white | Refrigerant | R290 |
| Internal floor | 304 Stainless steel | Temp. Range in box | (R) 34°F — 38°F (F) -4°F — 10°F |
| Insulation | Polyurethane (CFC free) | Evaporator/Condenser | Aluminum + Copper |
| Shelves | Heavy duty, PVC coating – 3 or 4 layers | Condensing unit | Bottom |
| Lighting | LED | Door lock | Yes |

REFRIGERATION / FREEZERS

RapidsWholesale.com



Certified To ANSI/NSF 7 Standards





DETAILS AND DIMENSIONS

EGD-2DR-36-HC / EGD-2DF-36-HC

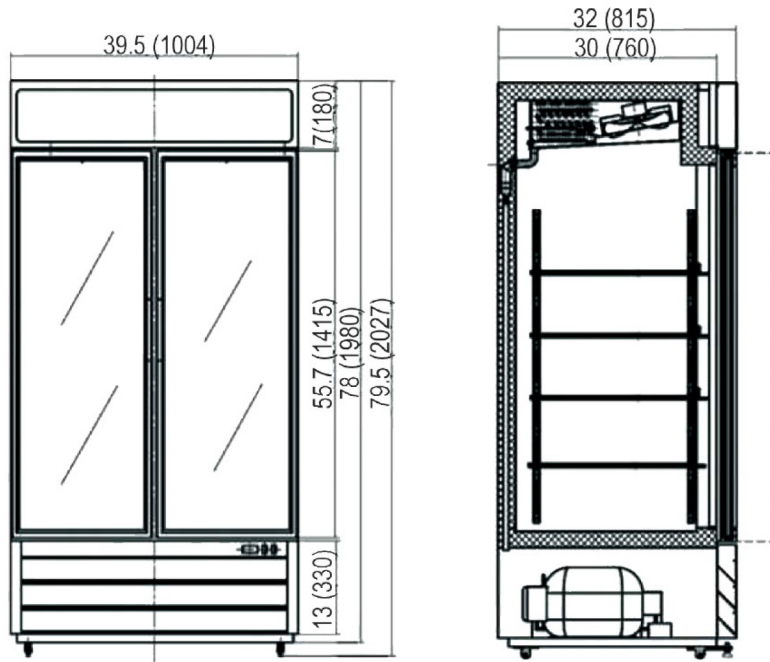

EGD-2DR-47-HC SIDE VIEW

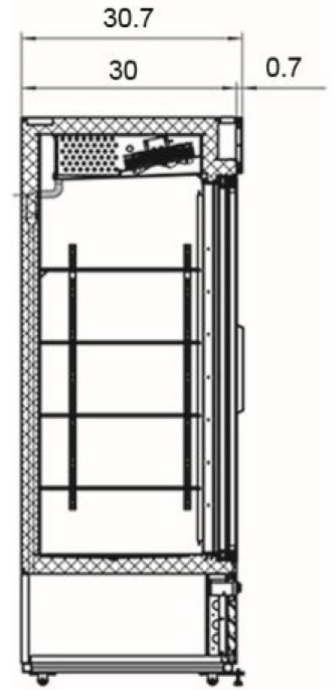

EGD-2DR-48-HC / EGD-2DF-48-HC

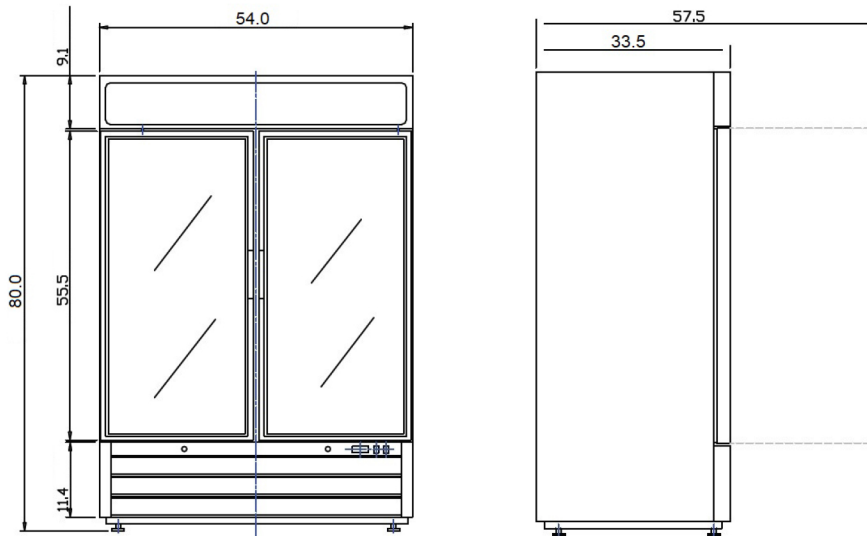

EGD-2DR-47-HC FRONT VIEW

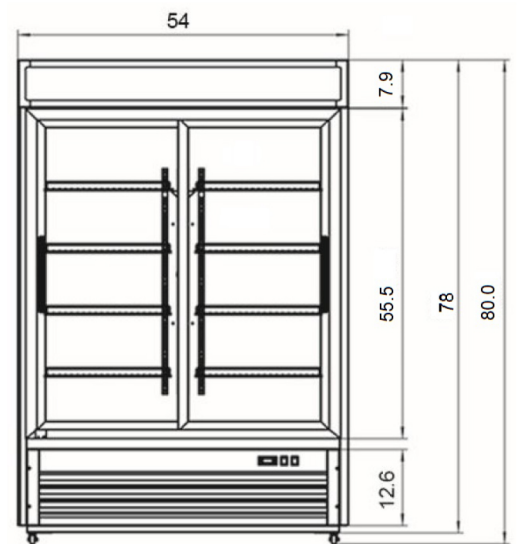

EGD-2DR-47-HC Sliding Glass Door opening is 20"

| Model | Doors | Shelves | Shelf Size (in) | Cabinet Dim (in) External | | | HP | Voltage /Hz /ph | Amp | NEMA Plug | Cord Lgth (ft) | Crated Weight (lbs) |
|----------------------|-------|---------|-----------------|---------------------------|------|------|-----|-----------------|-----|-----------|----------------|---------------------|
| | | | | W | D | H | | | | | | |
| EGD-2DR-36-HC | 2 | 8 | 16.41 x 24.33 | 39.5 | 32.0 | 79.5 | 1/5 | 115/60/1 | 3.0 | 5-15P | 9.8 | 375 |
| EGD-2DR-47-HC | 2 | 8 | 24.09 x 24.13 | 54.0 | 30.7 | 80.0 | 1/4 | 115/60/1 | 4.5 | 5-15P | 9.8 | 540 |
| EGD-2DR-48-HC | 2 | 8 | 23.15 x 26.14 | 54.0 | 33.5 | 80.0 | 1/4 | 115/60/1 | 4.5 | 5-15P | 9.8 | 540 |
| EGD-2DF-36-HC | 2 | 8 | 16.41 x 24.33 | 39.5 | 32.0 | 79.5 | 1/2 | 115/60/1 | 8.0 | 5-15P | 9.8 | 368 |
| EGD-2DF-48-HC | 2 | 8 | 23.15 x 26.14 | 54.0 | 33.5 | 80.0 | 1 | 115/60/1 | 9.0 | 5-15P | 9.8 | 567 |

★ Most commonly sold model

EGD-2DR-47-HC is a Sliding Door Model

